

# द्वि. वि. प्रा. द्वारका उपशहर परियोजना

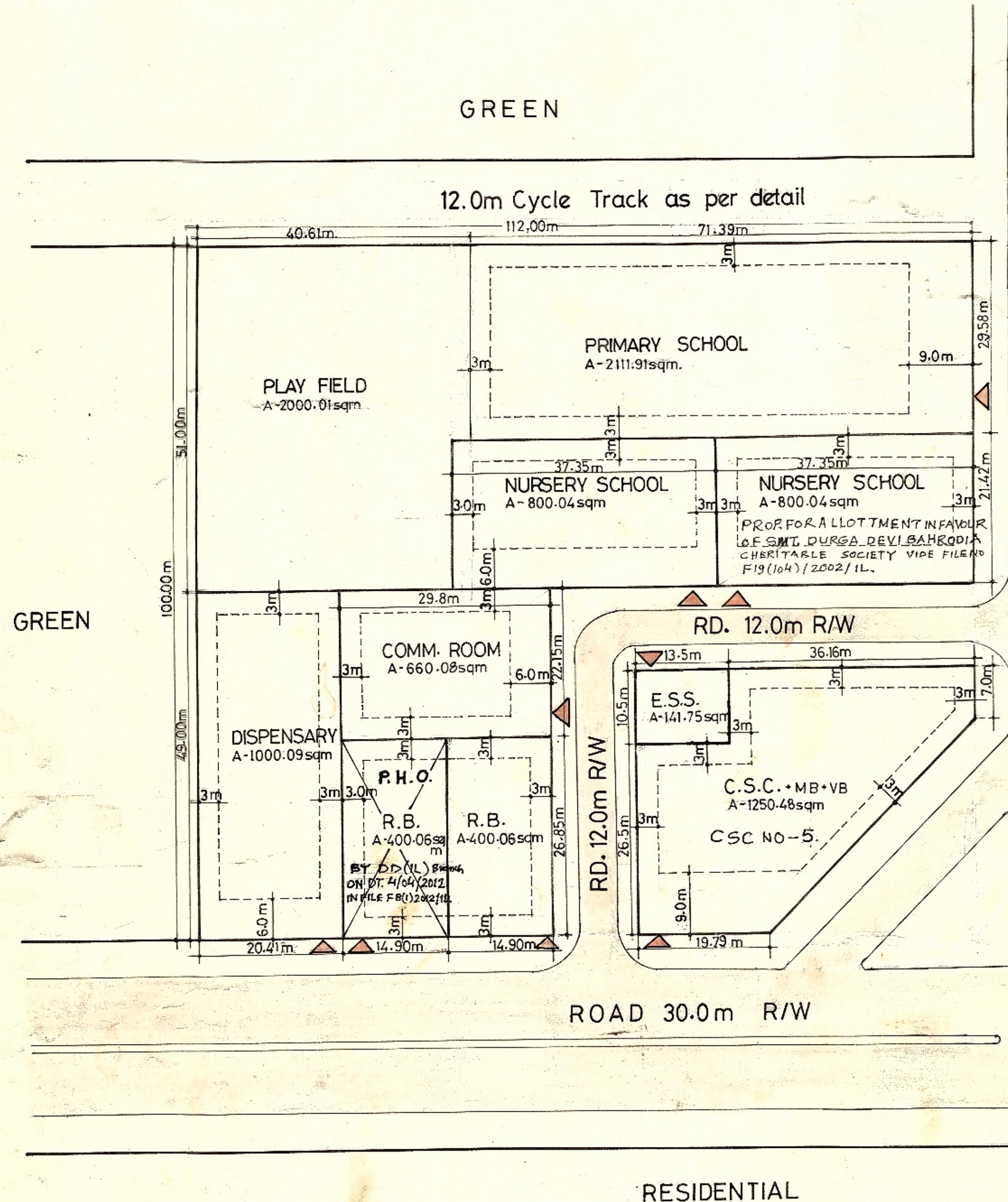

ROAD 30.0m R/W

H.A.F.

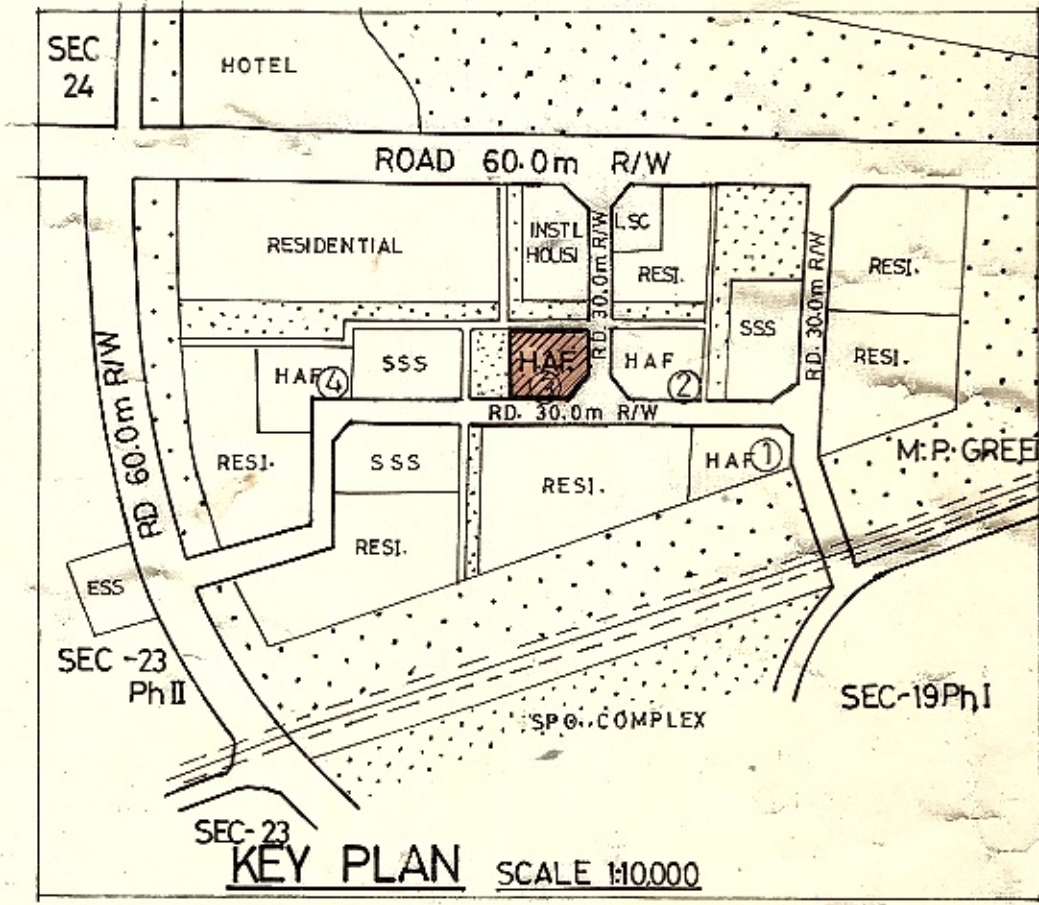

KEY PLAN SCALE 1:10000

- 1 THE PLAN IS SUBJECT TO MODIFICATION WITHIN THE FRAMEWORK OF MASTER PLAN / ZONAL PLAN.
- 2 IT IS FOR PLANNING PURPOSE & IS NOT FIT TO BE PRODUCED IN THE COURT OF LAW FOR PROPERTY DISPUTES.
- 3 ALL THE DIMENSIONS & AREA GIVEN IN THE PLAN ARE CONFIRMATION OF OWNERSHIP/ALLOTMENT STATUS & DEMARICATIONS/FEASIBILITY REPORT FROM THE DDA LANDS & ENGINEERING WING RESPECTIVELY.

## AREA STATEMENT

TOTAL AREA OF THE PLOT 10750 sqm.

Sr NO	FACILITY	PROPOSED AREA IN (sqm)	GR COVR	FAR	MAX HT IN (mts)
1	PRIMARY SCHOOL	4111.92			
2	DISPENSARY	1000.09			
3	C.S.C.+MB+VB	1250.48			
4	COMMUNITY ROOM	660.08			
5	NURSARY SCHOOL-I	800.04			AS PER MPD. 2001
6	NURSARY SCHOOL-II	800.04			
7	RELIGIOUS I	400.06			
8	RELIGIOUS II	400.06			
9	E.S.S.	141.75			
10	CIRCULATION	1185.48			
TOTAL		10750.00			

## NOTES:-

1. DO NOT SCALE THE DRAWING FOLLOW ONLY THE WRITTEN DIMENSIONS.
2. ALL DIMENSION ARE IN METRES.
3. CHECK ALL THE DIMENSIONS AT SITE BEFORE EXECUTION.
4. PLAN HAS BEEN APPROVED BY THE COMM. PLG. D.D.A. VIDE FILE NO. F8(10)94-DWK/HAF B/PART II PAGE NO.3 DATED 26.6.97.
5. DIMENSIONS CHANGED/INCREASED IN ACCORDANCE WITH FEASIBILITY REPORT VEN BY EE WD-12 VIDE LETTER NO. DB-100/AE(P)/WD-12/UDA/1991 DT 10.12.97.

## HOUSING AREA FACILITY

PKT.-3

## SECTOR-19Ph-II

# DWARKA SUB-CITY (PAPANIKALA)

LAY OUT PLAN		DWK/SEC-19PH/HAF/97/36
0 5 10 15 20 25		DRG. NO.
		SCALE=1:500
PLG D/MAN	REETA SEHGAL PLG. ASST	JUNE 97 DATE
M.L. CHABRA ASST DIRECTOR	A.K. MANNA DY DIRECTOR	A.K. GUPTA DIRECTOR (DWARKA)
दिल्ली	विकास	प्राधिकरण